

23.3761 ACRES JONES ROAD

- WEST SIDE OF JONES ROAD JUST NORTH OF CYPRESSWOOD. BEHIND HP HEADQUARTERS.
- APROX. 6 USABLE ACRES WITH APROX 1000 FEET OF FRONTAGE ON JONES ROAD.
- IDEAL LOCATION FOR OFFICE ENCLAVE, MEDICAL OFFICE, OR ESTATE HOMES.
- UTILITIES AVAILABLE

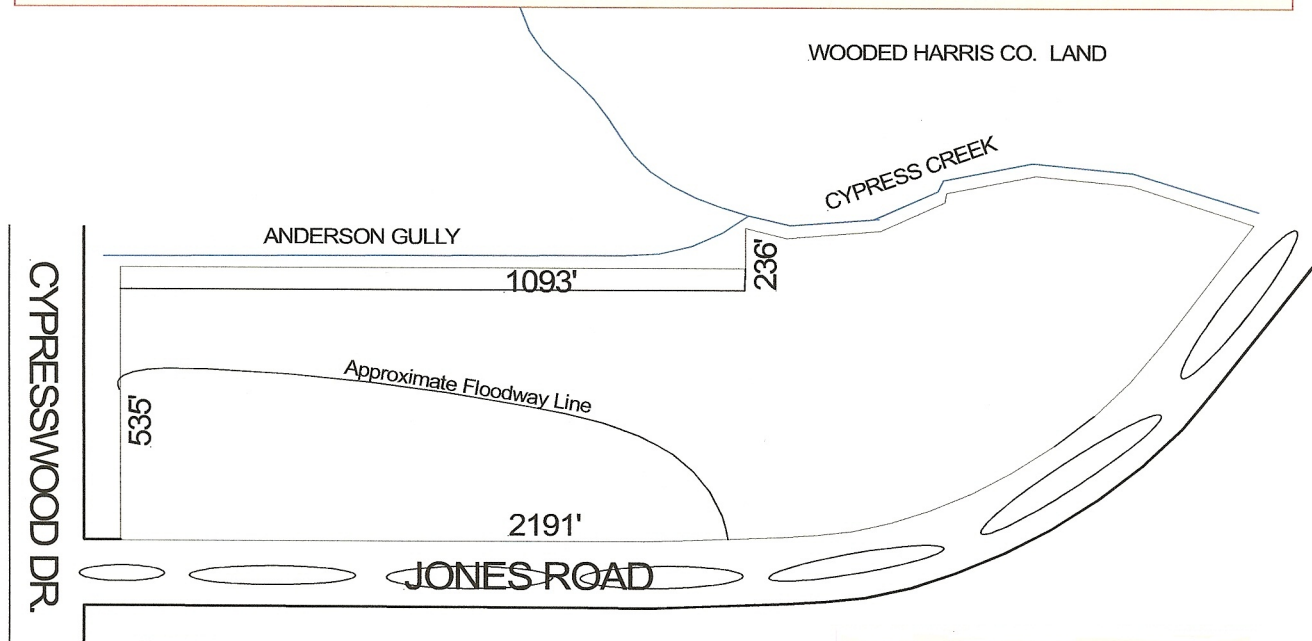

Contact:

TERPSTRA & ASSOCIATES

281-580-4855 OFFICE

281-580-3808 FAX

terprealestate@mindspring.com